

Centrometal

HEATING TECHNIQUE

BioTec-C / BioTec-L - place the boiler on the installation site

FORBIDDEN!

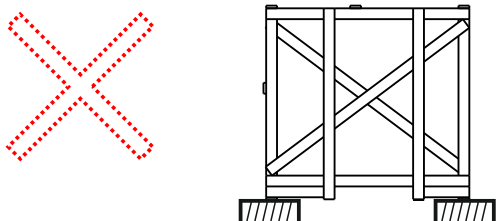

ALLOWED!

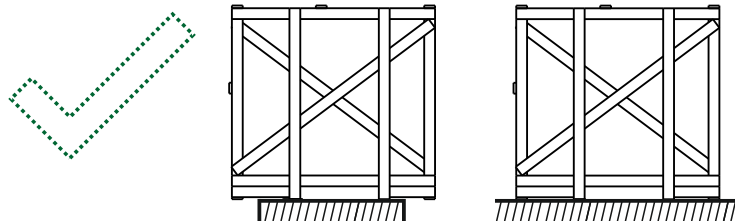

1.



2.



3.

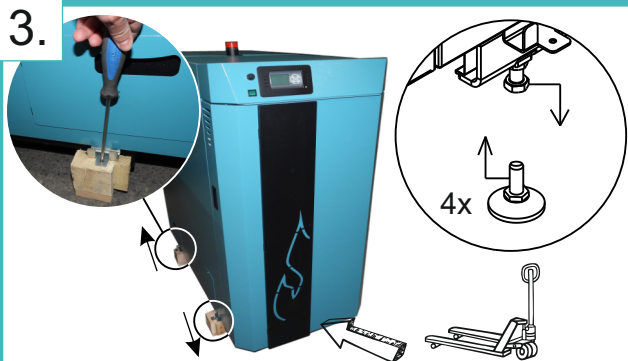

4.



1. The boiler is supplied on a wooden stand (pedestal) protected by a wooden box and PVC foil. The wood box and the PVC foil must be removed before/when placing the boiler to the position of installation.
2. After removing the wooden box and the PVC foil, leave the boiler on a wooden stand (pedestal) affixed with metal plates and screws (the possibility of manipulating (moving) the boiler, position of the hand forklift: on side or front side).
3. Place the hand forklift under the boiler mandatory from the front side (25 kW - 1 fork, 34/35/45 - 2 forks), unscrew the screws that hold the wooden stand (pedestal), remove them to separate the boiler and the wooden stand (pedestal). Slightly lift the boiler with a hand forklift so that it can be possible to remove the wooden stand (pedestal) (mandatory, the boiler 25 kW has to be supported (take care of the boiler) by the other person all the time from the start to the end of the lifting (including the manipulation and moving wooden parts)) and remove the existing legs (screws) and put the legs with the plastic slipper that came with the boiler in the plastic bag.
4. Place the boiler to the position of installation and slightly lower it to the floor. Remove the hand forklift.
5. Level the boiler using the 4x plastic slipper that you have fitted to the boiler stand.